

- ① Concrete Roof Slab laid to Fall
- ② Equus/De Boer DuO Primer
- ③ Equus Vapour Barrier
- ④ Equus PIR Thermal Insulation Board
- ⑤ Equus/De Boer Basesheet, Mechanically Fastened
- ⑥ Equus/De Boer Capsheet DuO HT 4 Slates/F C180 FireCare, fully bonded
- ⑦ Equus/De Boer Capsheet as separate piece over concrete Plinth, fully bonded
- ⑧ Angle Fillet
- ⑨ Concrete Plinth
- ⑩ Equus/De Boer Capsheet as extra piece in case of heavy loads, fully bonded
- ⑪ Bracket fixing with Neoprene Washer
- ⑫ Equipment Bracket

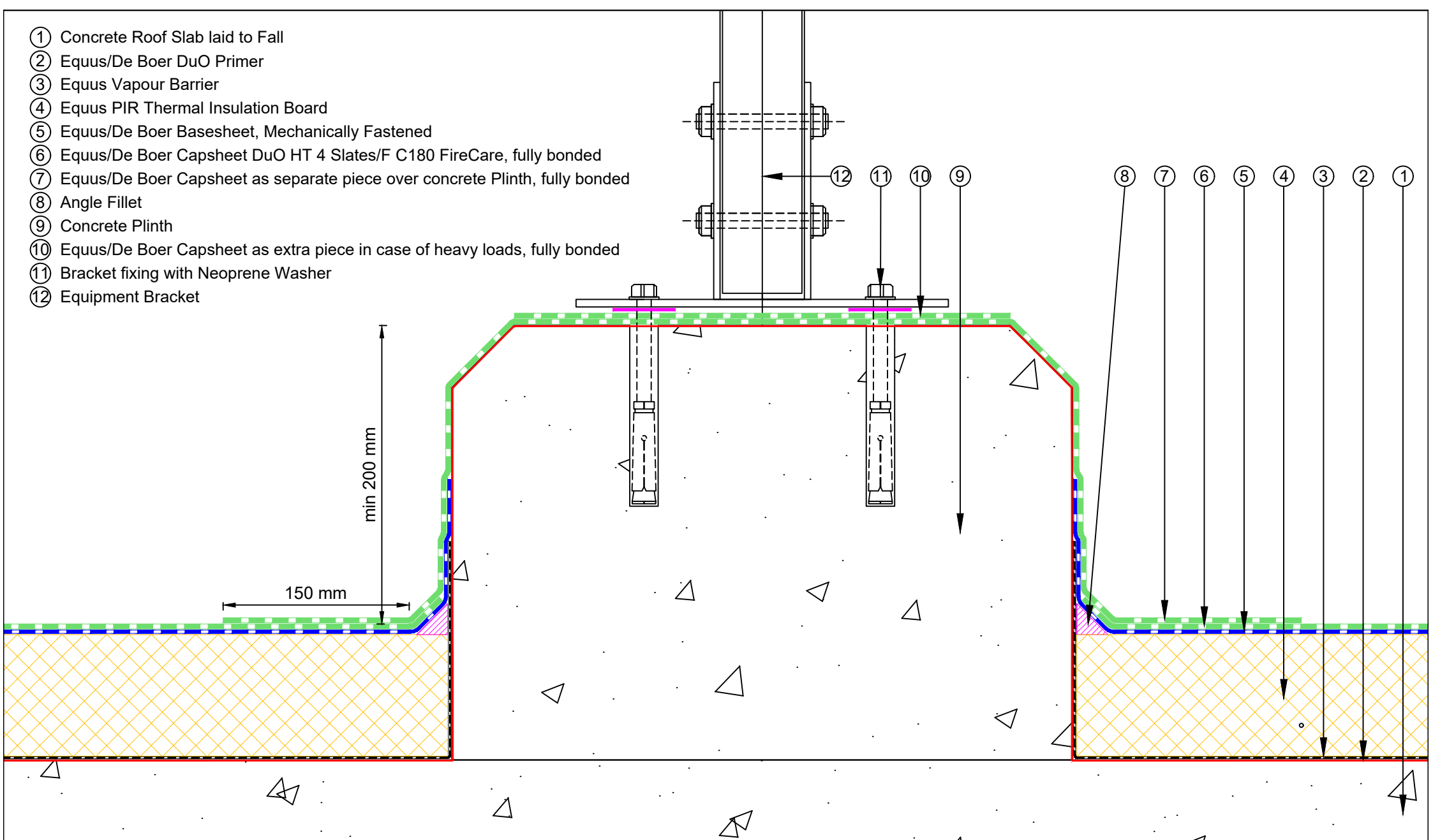

**equus**  
 E-mail : [admin@equus.co.nz](mailto:admin@equus.co.nz)  
 Web : [www.equus.co.nz](http://www.equus.co.nz)

**DuOtherm Warm Roof on Concrete  
 Concrete Footing  
 for Heavy Equipment Detail**

Equus/De Boer Waterproof Membrane Details are specially drawn for use by Local Authorities, Building Contractors, Equus Applicators, Architects and design professionals. All details are drawn to assist in the development of project specific details. Details may be modified where necessary to accommodate job specific requirements but must be approved by Equus Industries Ltd. All components must be supplied by Equus Industries Ltd. Equus Industries Ltd. reserves the right to alter or upgrade details at any time without prior notice.

Drawing No:	<b>DBDTC-D14</b>
Scale:	1:4 @ A4
Drawn by:	NKT
Date:	02-Feb-2019



**de boer**  
 4 your roof  
 E-mail : [info@deboer.be](mailto:info@deboer.be)  
 Web : [www.deboer.be](http://www.deboer.be)