

- ① Concrete Roof slab laid to fall
- ② Equus/De Boer DuO Primer
- ③ Equus/De Boer Vapour Barrier
- ④ Equus PIR Thermal Insulation Board
- ⑤ Equus/Dexcell Roof Board
- ⑥ Equus/De Boer DuO Primer, diluted 1:1 with White Spirit
- ⑦ Equus/De Boer Basesheet
- ⑧ Equus/De Boer Capsheet DuO HT 4 Slates/F C180 FireCare
- ⑨ Timber Plinth, glued to Capsheet
- ⑩ Metal Framing Fixing with Neoprene Washer into Timber Plinth, but not through Capsheet underneath
- ⑪ Equus/De Boer Capsheet, as separate piece over Timber Plinth
- ⑫ Clip Ring Fixing with Neoprene Washer into Timber Plinth, but not through Capsheet underneath

A. Clip Ring

B. Metal Framing

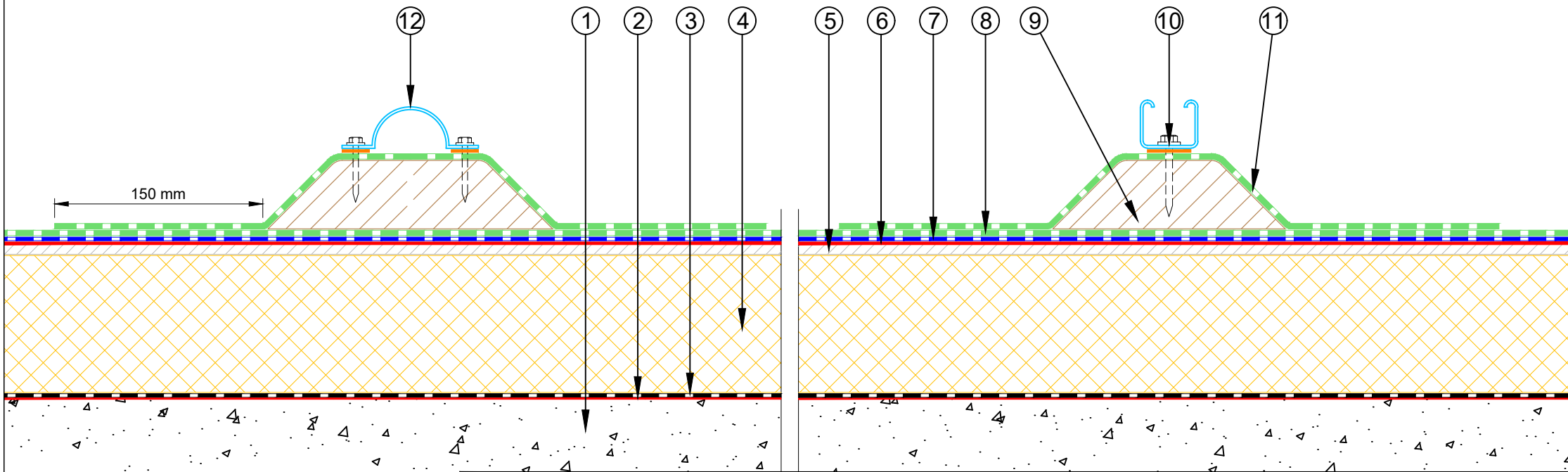

E-mail : admin@equus.co.nz
 Web : www.equus.co.nz

DuOtherm Warm Roof on Concrete Cable Tray Support Fixing Detail with Roof Board

Equus/De Boer Waterproof Membrane Details are specially drawn for use by Local Authorities, Building Contractors, Equus Applicators, Architects and design professionals. All details are drawn to assist in the development of project specific details. Details may be modified where necessary to accommodate job specific requirements but must be approved by Equus Industries Ltd. All components must be supplied by Equus Industries Ltd. Equus Industries Ltd. reserves the right to alter or upgrade details at any time without prior notice.

Drawing No:	DBDTC-D13b
Scale:	1:4 @ A4
Drawn by:	NKT
Date:	23/10/2017



de boer
 waterproofing solutions

E-mail : info@deboer.be
 Web : www.deboer.be